

RICOH

Caplio

Digital Camera Caplio 500G wide



Optical
3X Zoom
28mm-85mm

Effective
8.13
Megapixel
CCD



Built tough for construction sites

The user-friendly Caplio 500G wide — made durable for demanding environments.

Meet the demanding requirements of construction site photography with Caplio 500G wide. You can easily shoot clear photos with its renowned 28mm wide-angle zoom lens, 10m-range flash unit, and camera shake blur reduction. Plus high resistance to water, dust and shock let you focus on the scene without worrying about damaging the camera.



35mm



28mm

Wide coverage with 28mm wide-angle zoom lens

Ricoh's 28mm wide-angle zoom lens can capture larger areas than the 35mm lenses of conventional digital cameras. When there is limited space to maneuver, you can more easily capture an entire building or construction site with Caplio 500G wide.



Water, dust, bumps, and cold temperatures are no problem!

The compact Caplio 500G wide is much tougher than most other digital cameras. Durably built with reinforced glass shielding over the lens and strategically placed body protectors, it can withstand drops from heights of up to one meter*. JIS protection grade 7 allows shooting in the rain or underwater to a depth of one meter, and JIS protection grade 6 prevents small particles from entering the body at dusty construction sites. You can even shoot at temperatures as low as -10 centigrade.

*The test based on U.S. Department of Defense MIL-STD-810F procedures.



Large, easy-to-view 2.5-inch LCD screen

The large LCD screen features an anti-reflection coating for clearer viewing in daylight outdoors. You can easily adjust screen brightness to optimize image clarity. There is also an optical viewfinder, so you can use whichever is right for the situation, for more reliable photography.



Reliable 3-way power supply

Many hours of dependable shooting are yours with the high-capacity lithium-ion rechargeable battery. If it runs out of power, simply pop in widely available AA batteries. An AC adapter (option) is also provided for use when AC power is available.

Handy features simplify various on-site shooting tasks.

Caplio[®] 500G wide

Camera shake blur reduction

Caplio 500G wide effectively reduces camera shake blur by combining high ISO settings with fast shutter speeds. Now you can shoot with greater confidence in dark situation.

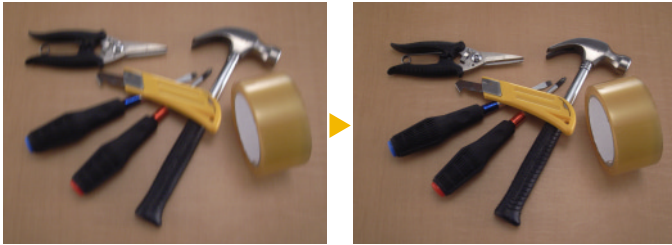

Powerful built-in flash

The built-in flash unit allows clearer shooting in a wider range of situations. Its powerful illumination extends 10 meters in wide-angle shots and 6.5 meters in telephoto shots.



USB2.0 High Speed support

Transferring large-volume image data from the camera to your PC is fast and easy with the provided USB cable. Enjoy single-action transfers, once bundled software is installed in your PC, or use Mass Storage Mode.



Vivid 1cm macro photography

Capture subjects as close as 1cm away in the macro wide-angle mode or 10cm away in the tele-macro mode. The built-in flash unit illuminates subjects as close as 20cm from the camera.

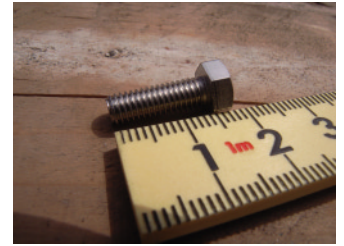

Large buttons and dials

All buttons and dials are large enough to ensure you can easily operate the camera even when wearing gloves.

Skew correction mode

This mode transforms trapezoids into rectangles. For example, a signboard shot at an angle can be corrected to appear as if shot directly from the front, for easier reading.

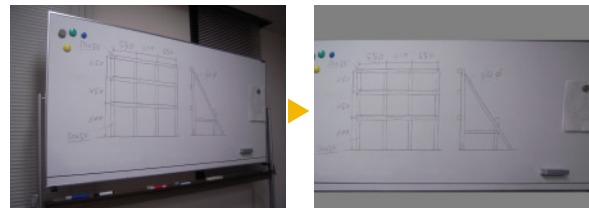

Two-point neck strap

The two-point neck strap lets you carry Caplio 500G wide securely around your neck for easy shooting when desired and less bouncing around.



Caplio 500G wide Major Specifications

Item	Description
CCD	Effective 8.13 million pixels (8.30 million square pixels), 1/1.8-inch primary-color CCD
Lens	Focal length f: 5.8-17.4mm (equivalent to 28-85mm for 35mm film cameras) Step-zoom intervals: 4 steps (28mm, 35mm, 50mm, 85mm) Aperture F: 2.5 (W)-4.3 (T)
Recording Media	SD Memory Card™(3.3V 32/64/128/256/512MB/1GB), Multi Media Card™, Built-in Memory 26MB
Recording Mode	Still mode (Continuous, S-Continuous, M-Continuous), Scene mode (High-sensitivity, Fire, Skew Correction, Text, Zoom Macro), Motion mode, Sound mode
LCD Monitor	2.5" translucent amorphous silicon TFT LCD (approx. 153,000 pixels)
Dimensions (WxDxH)	133.0 x 78.5 x 74.0mm (excluding projections)
Weight	Approx. 400g (excluding battery, SD Memory Card, hand strap) Accessories (battery, hand strap) approx. 50g
Power Source	Rechargeable battery (DB-43) x 1, AA battery x 2, AC adaptor (AC-4d)

Caplio 500G wide Optional Accessories

Accessory Name	
Wide conversion lens: DW-5	Battery Charger: BJ-2e
Rechargeable Lithium-Ion Battery Set (DB-43+BJ-2e): BS-3e	AC Adapter: AC-4d
Rechargeable Lithium-Ion Battery: DB-43	Soft Case: SC-500

● Caplio is the registered trademark of Ricoh Co., Ltd. ● Microsoft, Windows and Direct X are registered trademarks or trademarks of Microsoft Corporation in the U.S. and/or other countries. ● Apple, Macintosh and Mac OS are registered trademarks or trademarks of Apple Computer Inc. in the U.S. and/or other countries. ● The SD logo is a trademark. ● Compatible with EPSON PRINT Image Matching III. ● All other trademarks mentioned herein are the property of their respective owners.



For more information, visit:

http://www.ricoh.com/r_dc

RICOH

RICOH COMPANY, LTD.

3-2-3, Shin-yokohama
Kohoku-ku, Yokohama-shi 222-8530, Japan
Phone: 045-477-1738 Fax: 045-477-1797 http://www.ricoh.com/r_dc

RICOH EUROPE B.V. (PMMc EUROPE)

Oberrather Straße 6, D-40472
Düsseldorf, Germany
Phone: 0211-6546-0 Fax: 0211-6546-308 <http://www.ricohpmmc.com>

RICOH UK LTD. (PMMc UK)

Ricoh House, 1 Plane Tree Crescent, Feltham,
Middlesex, TW13 7HG, England
Phone: 0208-261-4000 Fax: 0208-261-4220

RICOH FRANCE S.A. (PMMc FRANCE)

383, Avenue du Général de Gaulle - BP 307-931-13
Clamart Cédex, France
Phone: 01-4094-3267 Fax: 01-4094-3276

RICOH ESPANA, S.A. (PMMc SPAIN)

Av. Litoral Mar, 12-14, 08005
Barcelona, Spain
Phone: 093-295-7600 Fax: 093-295-7605

RICOH ITALIA S.p.A. (PMMc ITALY)

via Ponchielli, 3
20063 Cernusco S/N Milano, Italy
Phone: +39-02-92361217 Fax: +39-02-92361244

RICOH HONG KONG LIMITED

Personal Multimedia Products Center
21/F., Tai Yau Building, 181 Johnston Road, Wan Chai, Hong Kong
Phone: 2862-2888 Fax: 2566-3647/2866-1120

RICOH AUSTRALIA PTY. LTD.

8 Rodborough Road, Frenchs Forest, N.S.W. 2086 Australia
Phone: 02-8977-1111 Fax: 02-8977-1100
<http://www.ricoh.com.au>

RICOH CORPORATION

5 Dedrick Place
West Caldwell, NJ 07006 U.S.A.
Phone: 1-800-Ricoh93 <http://www.ricoh-usa.com>